

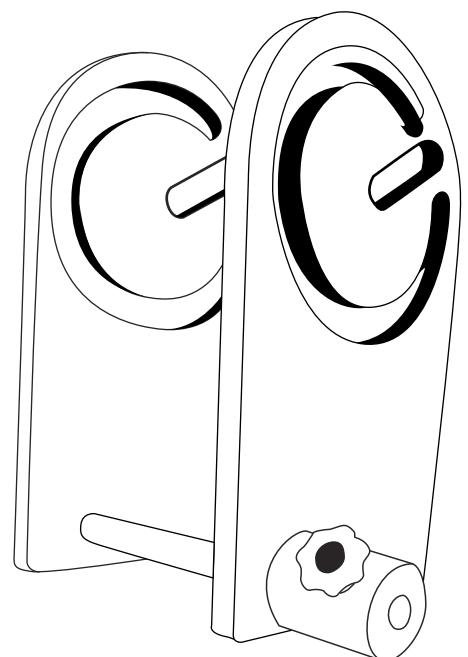

Great Engineering pty Ltd
www.greatengineering.com

7/11 Sabre Drive, Port Melbourne
Victoria, 3207, Australia
Ph: +613 9646 8688
Fax: +613 9646 3144

Interface and Label Guide manual



Label Guide Setup

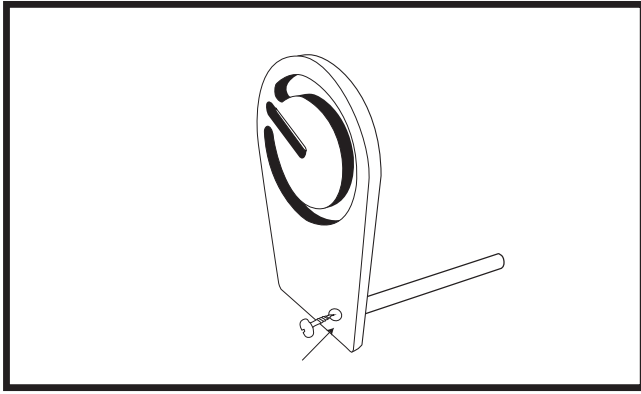

- ① Hold the shaft against the hole in the guide wall and screw in place

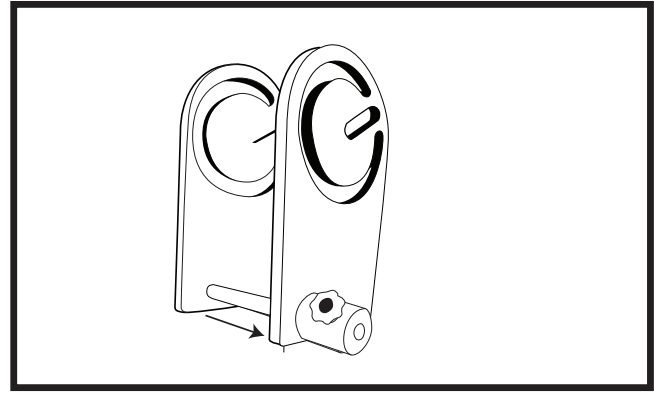

- ② Push the shaft through the other wall

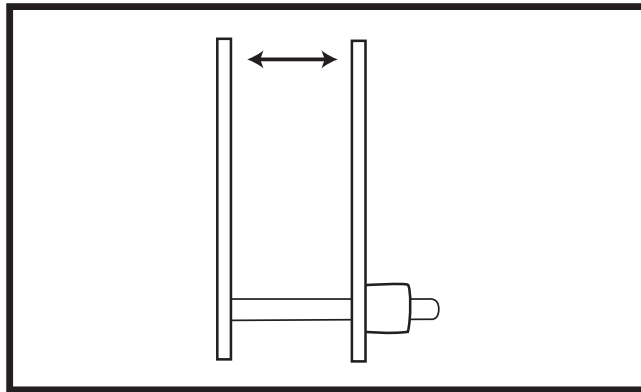

- ③ Make the distance between the walls slightly larger than the width of your label

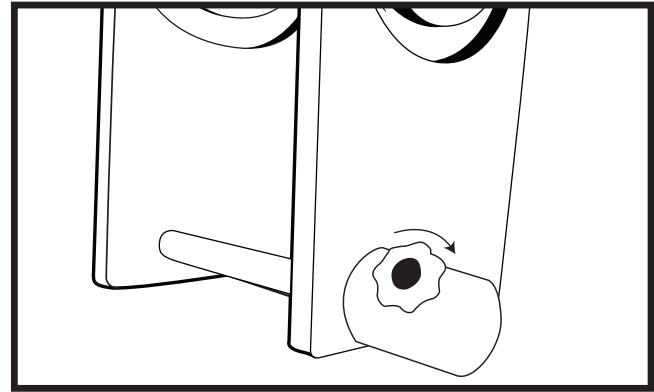

- ④ Turn the nob to tighten the screw to hold the shaft in place

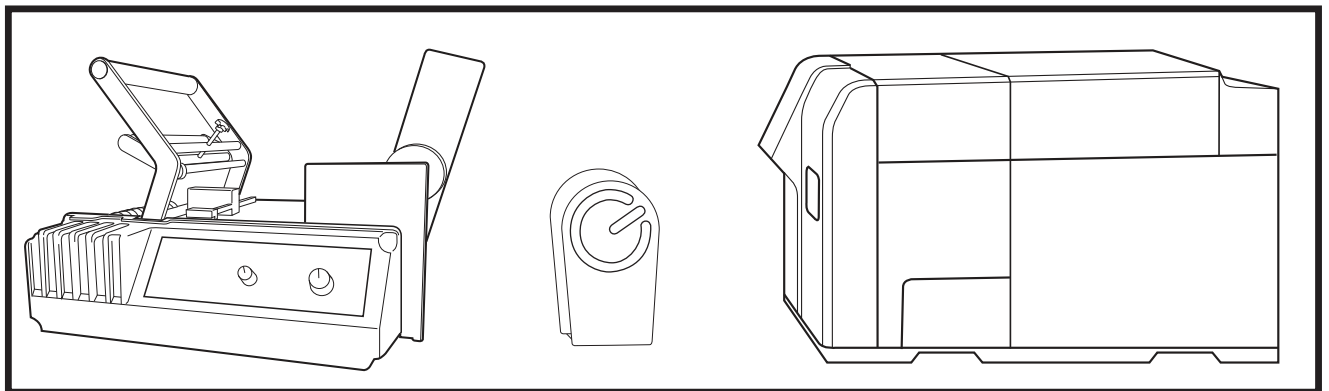

- ⑤ Place the guide in between the printer and the applicator

Printer Setup

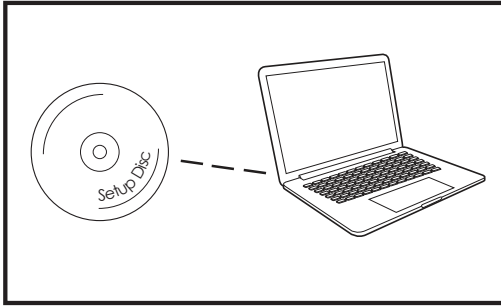

- ① Set up printer as per printer instructions.

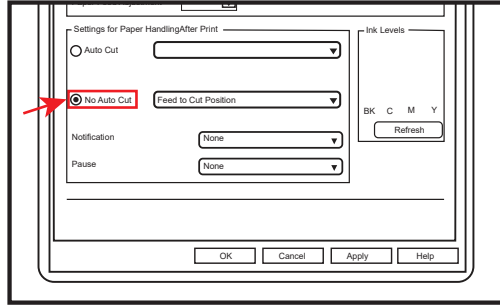

- ② Open label file and set printer properties. Auto cut must be turned off.

Applicator Setup

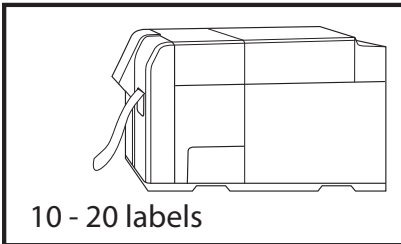

- ③ Print a batch of 10-20 labels to set up applicator.

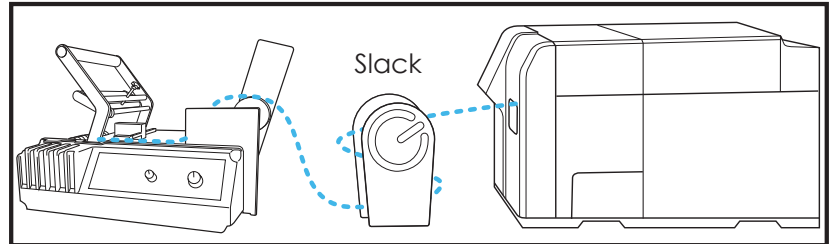

- ④ Using printed labels, set up applicator as per their instructions.

- ⑤ Leave label slack between printer and applicator
Note: To set up guide, refer to guide instructions

Interface Setup

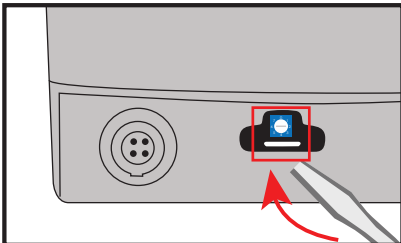

- ⑥ Using a small screwdriver turn the dial to the correct number for your computer system and program.
NOTE: Dial specifications in the table on the next page.

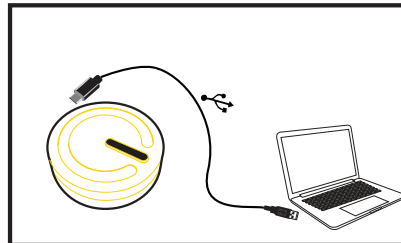

- ⑦ Plug USB cable into computer and Interface.

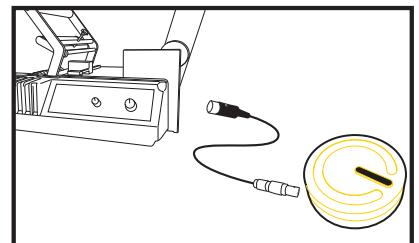

- ⑧ Plug applicator cable in to applicator and Interface.

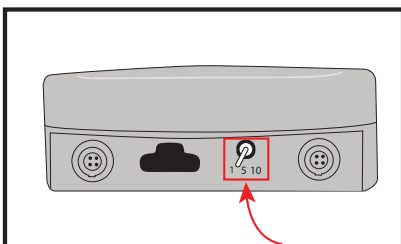

- ⑨ Select the print batch quantity you want, option: 1, 5 or 10.

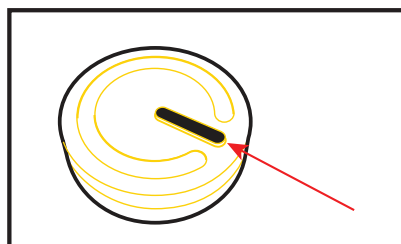

- ⑩ Click button on top of Interface to check it prints correctly

Dial settings 	Function/Operating System/Programs
Windows	
0	Function: Apply and print the quantity you have set OS: Windows Programs: Adobe Acrobat Reader DC, Adobe Acrobat Pro, Teklynx, Prisym, Microsoft Access and Nicelabel Designer*
1	Function: Apply and print the quantity you have set OS: Windows Programs: Bartender, Microsoft Outlook and Adobe Illustrator
2	Function: Apply and print the quantity you have set OS: Windows Programs: Adobe Reader, Microsoft Word, Microsoft Powerpoint and Microsoft Excel
3	Function: Apply 1 and print the quantity you have set OS: Windows Programs: Adobe Acrobat Reader DC, Adobe Acrobat Pro, Teklynx, Prisym, Microsoft Access and Nicelabel*
Macintosh	
6	Function: Apply and print the quantity you have set OS: Macintosh Programs: Preview, Adobe Illustrator, Adobe Photoshop, Microsoft Word, Microsoft Excel and Microsoft Powerpoint
7	Function: Apply and print the quantity you have set OS: Macintosh Programs: Adobe Reader, Acrobat Pro DC and Adobe Acrobat Reader DC

* Nicelabel Designer has a different set up. Set the quantity in the print dialogue to match the quantity chosen on the interface.

NOTE: If you change the dial number, the Interface needs to be turned on and off by taking out and putting back in the USB device.